

**Stretcher Fitting Assemblies**

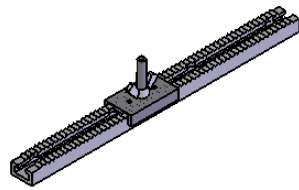

0023 Flat Serrated Type

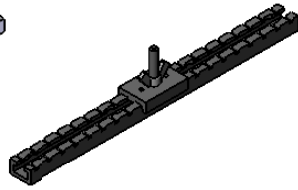

0023E Flat Castle Type

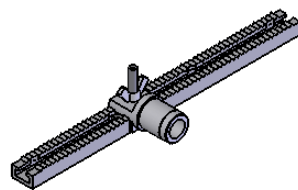

0036E Tube Serrated Type

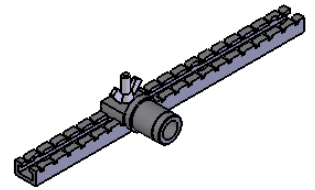

0036EE Tube Castle Type

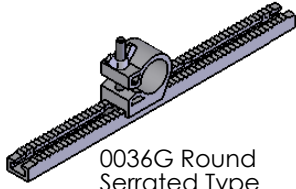

0036G Round Serrated Type

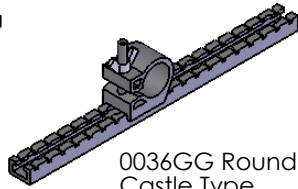

0036GG Round Castle Type

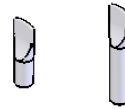

S/S Cyl. Nut  
0023B M6X40  
0023C M6X60



Nylon M6 Nut  
0023D



S/S Tee Bolt  
0023A M6 X 35mm  
0023J M6 X 55mm

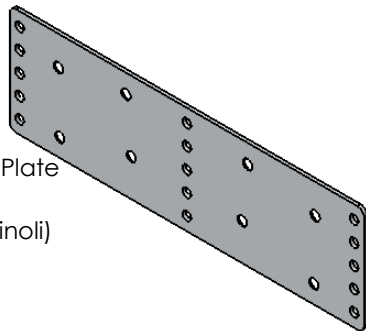

Shoe Plate  
0332  
(Martinoli)

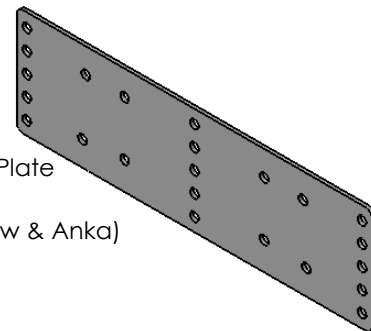

Shoe Plate  
0332  
(H2Row & Anka)

**Seat Rails / Slides only**

- 0013 760mm
- 0013A 810mm
- 0013AA 840mm

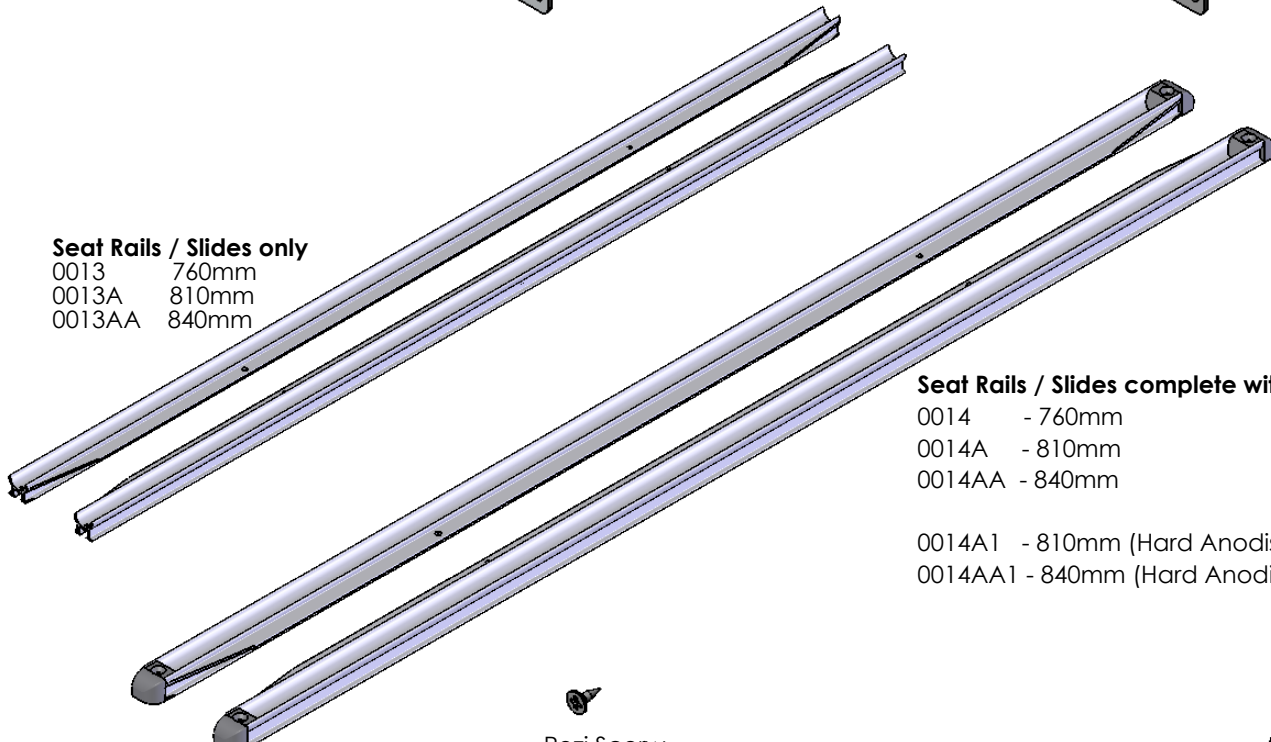

**Seat Rails / Slides complete with stops**

- 0014 - 760mm
- 0014A - 810mm
- 0014AA - 840mm
- 0014A1 - 810mm (Hard Anodised)
- 0014AA1 - 840mm (Hard Anodised)



Pozi Scerw  
0014K



M5 X 10 Shoe Fixing Screw  
0332B  
(H2Row & Anka)



M6 X 10 Shoe Fixing Screw  
0332A  
(Martinoli)

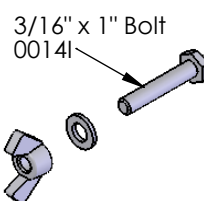

1.0" Rail Fixing Bolt Assem.

3/16" x 1.5" Bolt

0014J

3/16" S/S Washer

3/16" S/S Wing Nut  
0014G

1.5" Rail Fixing Bolt Assem.



Rail Stops LH/RH  
0014B